



Inside your newsletter this week:

Page 2 : Mrs Slade

Page 3 : This Week at Slade

Page 4 : Around School

Page 5 : Around School

Page 6 : Slade Stats

Page 7 : Our Communication to you

Page 8 : Coming Up...

#### **IMPORTANT NOTICE**

There have recently been a couple of cases of head lice identified in school. While lice are nothing more than a nuisance, it is important that pupils are checked on a weekly basis so that any head lice can be dealt with quickly and before they can be allowed to spread. As there have been a couple of cases, we would ask you to check your daughter's/son's head as soon as possible.

For further information on head lice please see your pharmacist or visit <https://www.nhs.uk/conditions/>

Slade Primary School Newsletter 2020/21 Term 2 Issue 2 / Friday 13 November 2020



Live Updates and the  
Latest News  
[@sladeprimarysch](https://twitter.com/sladeprimarysch)



The Slade App from Arbor  
Everything you need from  
us for you.



Keep in contact:  
[office@slade.kent.sch.uk](mailto:office@slade.kent.sch.uk)  
01732 350354



# From the Headteacher

## Karen Slade

**Dear Parents and Carers,**

Many thanks to all parents and carers who have adapted so very quickly to the changes that we introduced at the start of this week at drop off and pick up times. Your co-operation and understanding is very much appreciated as we work together to keep all of our school community safe at this challenging time. This week the government updated their guidance for parents and carers which can be found by accessing the following link: [https://www.gov.uk/government/publications/what-parents-and-carers-need-to-know-about-early-years-providers-schools-and-colleges-during-the-coronavirus-covid-19-outbreak?utm\\_source=12%20November%202020%20C19&utm\\_medium=Daily%20Email%20C19&utm\\_campaign=DfE%20C19](https://www.gov.uk/government/publications/what-parents-and-carers-need-to-know-about-early-years-providers-schools-and-colleges-during-the-coronavirus-covid-19-outbreak?utm_source=12%20November%202020%20C19&utm_medium=Daily%20Email%20C19&utm_campaign=DfE%20C19)

Well done and thank you to everyone for supporting us with our fundraising for BBC Children in Need. We've all been very spotty today in our 'own clothes' which made for a very colourful Zoom celebration assembly this afternoon. Thank you to everyone who supported the inter class competition with your creative Pudsey Bears; we have loved seeing your imaginative creations! Thanks to everyone's generosity, at the time of writing, we have already raised an amazing £493!! Well done and thank you all.

On Wednesday, the whole school came together, albeit virtually, to commemorate Remembrance Day, honouring those who have lost their lives in combat during wartime. All children joined me from their classes via Zoom as I led our short ceremony from the playground, supported by Sprite Class and members of staff. This year was especially poignant as we also took time to reflect on the time in which we now live. Photos from the ceremony have been shared on our Twitter feed if you wanted to take a look.

This week we have held two 'Open Morning' question and answer sessions for prospective parents currently looking to choose a school for children who are due to start in September 2021. The sessions were an opportunity to visit our virtual chat room to hear about the provision on offer here at Slade followed by time to ask questions of some of the Leadership Team! This was after they had all viewed the presentation and film on the Open Morning section of our school website. If anyone you know is in the process of selecting a school for their child then do please signpost them to our website or they can email the school on [admissiona@slade.kent.sch.uk](mailto:admissiona@slade.kent.sch.uk) for further information.

A reminder please for all pedestrians to take care when crossing roads at drop off and pick up times and to listen to the guidance Mrs Dolley gives when using the road crossing patrol, including not crossing the road behind her. Materials to support you teach your child how to stay safe when crossing the road can be found at <https://www.think.gov.uk/>

I look forward to seeing everyone wearing their odd socks to school on Monday as we all celebrate our individuality as part of 'Friendship Week!'

Take care, stay safe and be kind.

**Karen Slade**





# This Week at Slade

## Connecting the Bubbles!

**School is back, albeit in a bubbled form. The newsletter will be bringing you weekly news from around the year groups so that the children and parents alike can see what is happening across Slade since it is difficult to keep abreast of how everyone is and what they are up to at the moment.**

This week we have news from Year 1, Year 2 and Year 5. Thank you to Mrs Hill, Miss Redden and Mr Watts for their contributions.

### Year 1, Elf

At the beginning of the week Year 1 began their new Geography topic 'Why can't penguins fly?' by flying to Antarctica. The children all had their boarding passes at the ready as they boarded their virtual flight. They enjoyed looking out the window of the plane at the view as they flew over the ice. Once the plane had landed the children explored Antarctica virtually. They children enjoyed talking about what they could see and how the landscape was different to Tonbridge before boarding the plane once again and travelling back to Slade just in time to go home.

*"The airplane went to Antarctica. I liked watching the plane take off on the TV. I wouldn't like to live in Antarctica because the Polar bears might eat me"* Mabel

*"We went on an aeroplane to Antarctica. We saw a video and it was snowy and mountainy"* Alfie

*"I liked flying to Antarctica because I was excited to fly. If I lived there I would need a hat, scarf and gloves."* Jacob

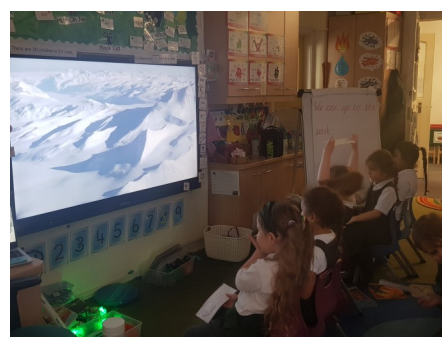

### Year 2, Sprite

This week in Sprite Class we have been readying the story of Dave and Violet. We have looked at the words used in the text and sequenced pictures to show the order. In Maths we have been looking at the link between subtraction and adding. Within History we have finished our unit on the Titanic and created Newspaper reports to recount what happen. Finally, we enjoyed our first Forest School session on Wednesday.



### Year 5, Wyvern

Wyvern have had a fantastic week. On Monday afternoon, we had an excellent discussion about whether the Trojan Horse story is completely factual or if it might be a myth. On Tuesday afternoon, Wyvern wowed me with the progress that they've made in Basketball. There was some really good dribbling and shielding on show. Finally, today we had a fascinating discussion about Remembrance Day. We talked about some of our ancestors who fought and I told them a bit about John Hills, a 19 year old former Slade pupil who joined the RAF and, sadly, lost his life during World War II. I wanted them to understand that, even though these people lived a long time ago and their pictures are in black and white, they are real people who grew up in our area and walked the same streets and corridors as us.

**\* STOP PRESS \***

Elmer and Gruffalo class photos are in today's Kent and Sussex Courier (for 1 week only)

Don't forget to buy your copy!





# Around School

## Children In Need 2020

There has been a very lively and happy atmosphere in school today, as all the children have been celebrating Children In Need 2020. They have all come in their colourful own clothes, and via Zoom have been sharing their photos of creations based on Pudsey Bear, and voting for their favourites. Winners will earn themselves a gold Pudsey pin. Look out next week in the newsletter where we will be sharing photos of the winning creations. We have not asked children to bring in money this year but if you would like to donate please go to the following link <https://www.justgiving.com/fundraising/cin2020-1722180>



## Forest School Update

There has been more exciting work happening down at the forest school over the weekend. A very big thank you to Mrs Young and Andy, who gave up some of their time on Saturday to come and build us a mud kitchen and a seesaw.



## Reading Room Project

Following on from the success of the transformation of the old music mobile classroom into the 'wobble' room (a safe place for emotional time out) created by our Artist in Residence, Rob and assisted by some of our children, we are excited to announce another project.

Our 'group room' is to be transformed into a 'reading room' or 'book nook'. This will be a place to inspire and engage children, to reflect the love of reading and the magical and wonderful worlds that books can take you to, a quiet place for children to go and read or to be read to. This is at the very early stages of planning, and Rob is currently holding workshops with KS1 and KS2 children to gather their input on how they would like the room to be. Rob has created a 3D model of the room, and the children can use this to experiment with ideas.

We will keep you posted via the newsletter and twitter on how the project is progressing.

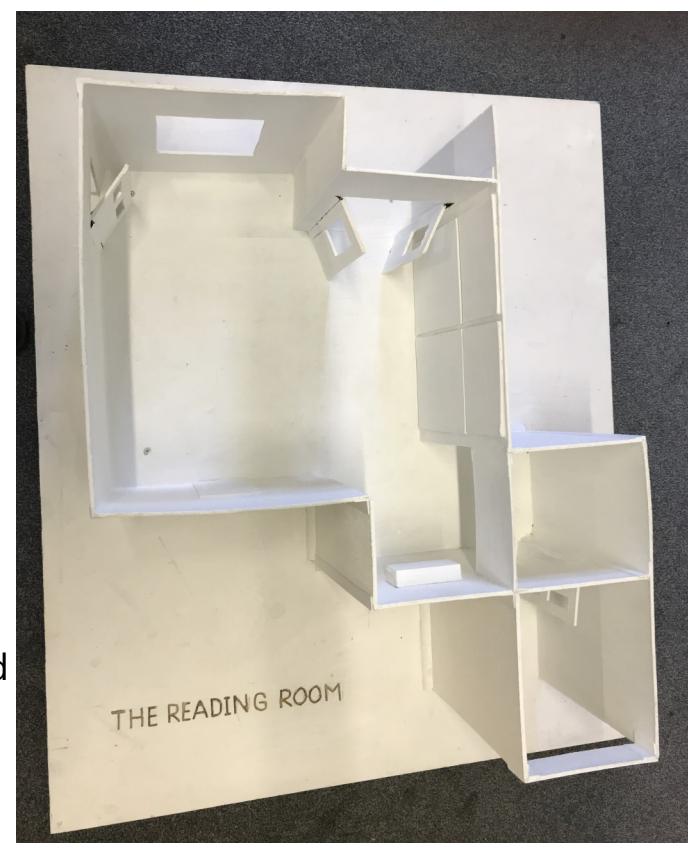





# Around School

## Reading Corner

As you know, reading is the lifeblood to all of our learning and we are keen as ever this year to see all of our children enjoying their reading - whether it be reading their school book out loud to their family at home, or with their nose in a comic or magazine, book from the library or looking at information from their latest topic. We will be continuing our Reading Corner column in the newsletter this year, with Book of the Week, news from the Library and any other information of interest relating to reading.

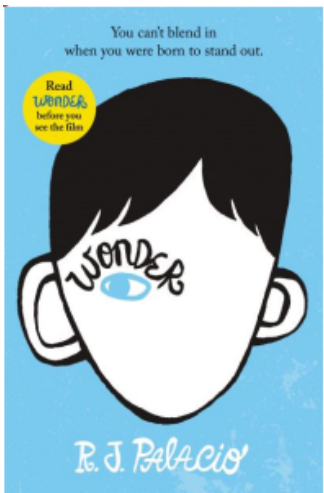

### Book of the Week/Wonder

An extremely moving tale of August Pullman., a boy born with a facial deformity. It tells the story of his school and home life and how he faces the challenges it brings. This is such a powerful and funny read that explores how people react with each other and how adults and children behave differently. It is also told from different characters' perspectives. Wonder is an engaging and thought provoking read, one to pass on to others and remember long after the final page.

## A Beautiful Fundraising Book

This book is a collection of poems, artwork and reflections including a lovely story and poem written by sisters Sofia and Anna (Dragon and Elf class). The book is beautifully illustrated and 100% of the proceeds will be donated to NHS Charities Together. The book will be available to purchase from the 30th November 2020, and will be a fantastic resource to look back on how families coped during this time.



## Reading and autism in young children

Making reading a fun activity can help an autistic child with learning and social skills. Sharing books is a great way to connect and can help with language development and listening. Here are a few tips to help when reading with young children:

- Sit on the floor together
- Read for only short periods of time to start with, pointing and naming objects as you read
- Look at books that have photos of babies and people's faces. This can help recognise emotions
  - Read the same story repetitively and find books that have repetition and rhymes
    - Talk about pictures while reading the text
    - Share books on topics that interest your child
  - Find books that have buttons to press to make sounds

More information can be found at [www.readingrockets.org](http://www.readingrockets.org)





# Slade Stats.

Over a school year, we are due to be open for 190 days which equates to 380 sessions (morning and afternoon.)

Attendance is affected if a pupil is not present at school for any whole session including registration.

The class with the best attendance each week will win Attendance Ted.

Attendance Target. 97%

Attendance This Week. 96.9%

Attendance This Year. 96.9%

Registers are taken 10 minutes after the school gates close for your child's year group.

It is important that the children are at school on time every day to prevent disruption and upset to their day and for the rest of their class and to prevent unnecessary crossing in to bubble groups by adults escorting late children.

Punctuality Pup is awarded to the class with the best punctuality each week.

Pupils late this week. 7

Free Online Christmas Craft Courses — Visit [www.kentadulteducation.co.uk](http://www.kentadulteducation.co.uk) or 03000 41 40 25 to book your place!

- **Christmas Crochet - Glasses Case** Tue 17th Nov 10.00-13.00
- **Felt Christmas Crafts** Mon 23rd Nov 09.30-12.30
- **Celebratory Bunting** Wed 25th Nov 09.30-12.30
- **Christmas Crochet - Hot Pot Holder** Wed 25th Nov 12.30-15.30
- **Celebratory Bunting** Tues 1st December 9.30-12.30
- **Wacky Animals in Bright Bold Colours using Acrylic** Tues 1st Dec 09.30-12.30
- **Repurposing Buried Treasures - Jewellery** Wed 2nd Dec 09:30-12:30
- **Felt Christmas Crafts** Mon 7th Dec 18.30-21.30
- **Wacky Animals in Bright Bold Colours using Acrylic** Tue 8th Dec 13.30-16.30
- **Repurposing Buried Treasures - Jewellery** Wed 9th Dec 09:30-12:3





# Dear Parents & Carers



Every parent and carer is entitled to access our Slade App and desktop dashboard from Arbor. By signing up you will be able to access personal information relating to your child as well as a one station stop for finding all of our communications to you personally, your child’s class or year group as well as all school letters, payment for special lessons and school trips and booking for parents evenings and all ticket events at school.

**All we ask is one thing: please take the time to read emails sent to you, we try to make sure that everything you are sent relates to your child, so nothing is irrelevant. If you would like further information on any email we send, please contact the class teacher or the school office for assistance.**

We also encourage you to follow us on Twitter, we post reminders, useful information, live updates from school and other community events of interest.

Don’t miss out, or let your child miss out, please keep up to date with everything Slade via Arbor and Twitter.

**This is a full list of everything sent out this week:**

Date of Communication	Subject	Sent To
Monday 9 November	PTA Meeting	All School—Email
Monday 9 November	Forest School	
Tuesday 10 November	Friendship week/Odd Socks Day	All school—Email
Wednesday 11 November	Armistice Day	
Wednesday 11 November	New Parents Q&A Session	
Wednesday 11 November	Narnians update	All school—Email
Wednesday 11 November	Hydra Class Start Times	Hydra Class—Email







# For your Diary

## Next Week :

Day	Event
Monday 16 November	Friendship week Odd Socks Day
Tuesday 17 November	
Wednesday 18 November	
Thursday 19 November	
Friday 20 November	

## Extra Curricular Clubs Next Week :

MONDAY	All Clubs, Extra Curricular Activities and Narnians Wraparound suspended in Term 1
TUESDAY	All Clubs, Extra Curricular Activities and Narnians Wraparound suspended in Term 1
WEDNESDAY	All Clubs, Extra Curricular Activities and Narnians Wraparound suspended in Term 1
THURSDAY	All Clubs, Extra Curricular Activities and Narnians Wraparound suspended in Term 1
FRIDAY	All Clubs, Extra Curricular Activities and Narnians Wraparound suspended in Term 1

## Further Ahead :

Thursday 26 November	<b>NHS Childhood Influenza Immunisation Day</b> All children are eligible and are advised to have the flu spray this year Further information and consent forms will be issued nearer the time
Friday 18 December	<b>Last day of Term 2</b>
Monday 21 December — Friday 1 January 2021	Christmas Break, School Closed
Monday 4 January	<b>First Day of Term 3</b>